

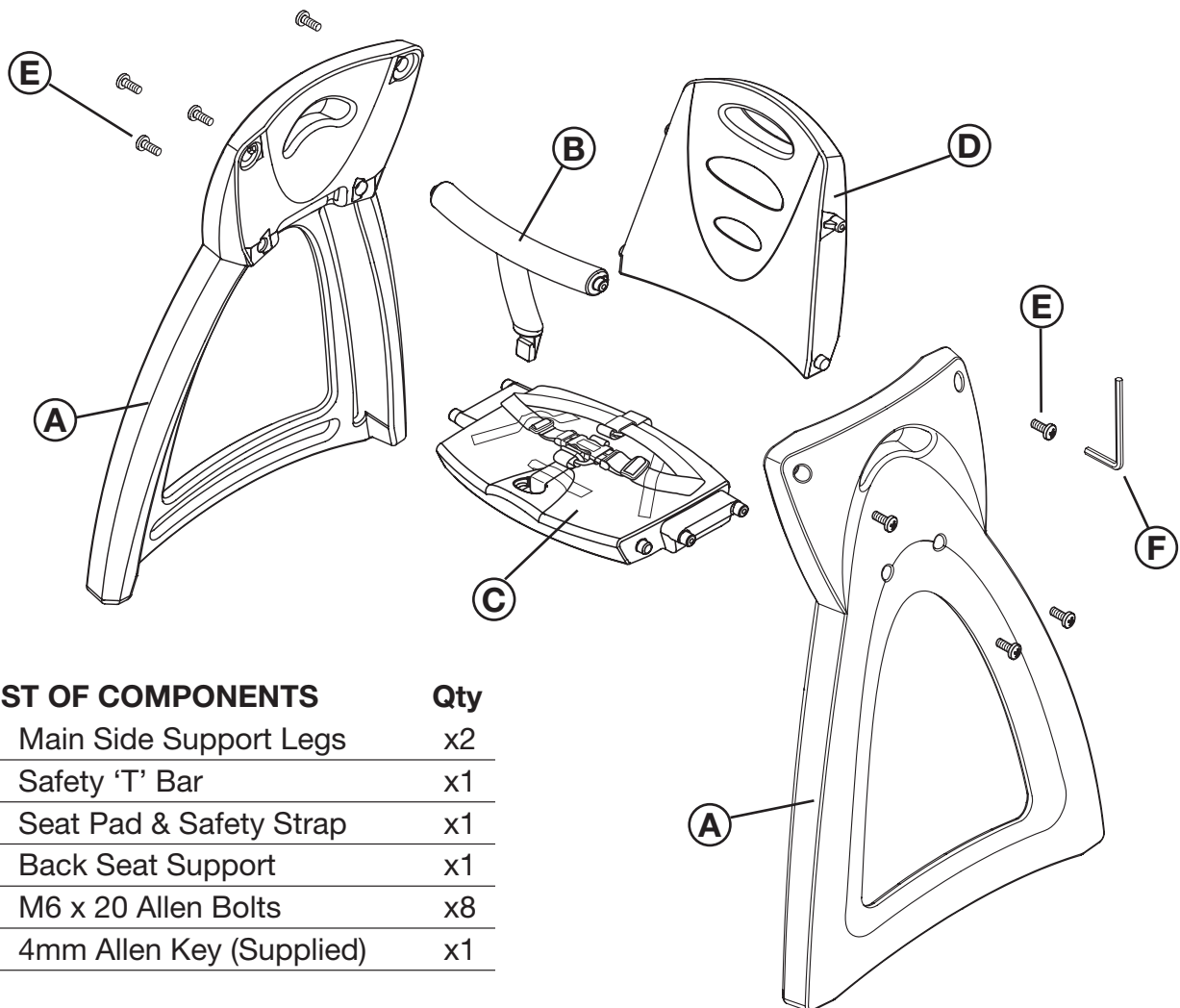

M212 Breeze High Chair Assembly Instructions



LIST OF COMPONENTS	Qty
A Main Side Support Legs	x2
B Safety 'T' Bar	x1
C Seat Pad & Safety Strap	x1
D Back Seat Support	x1
E M6 x 20 Allen Bolts	x8
F 4mm Allen Key (Supplied)	x1

1

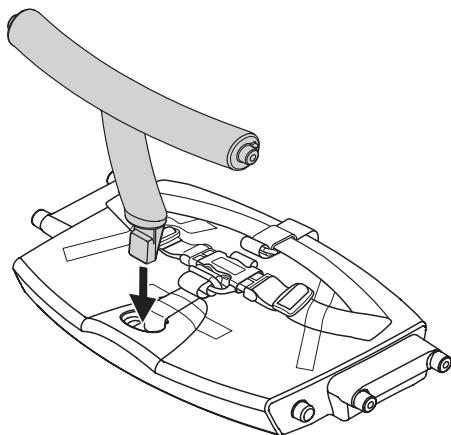

Insert 'T' Bar into Seat Pad
Note: Leave Safety Strap Taped to Seat Pad

2

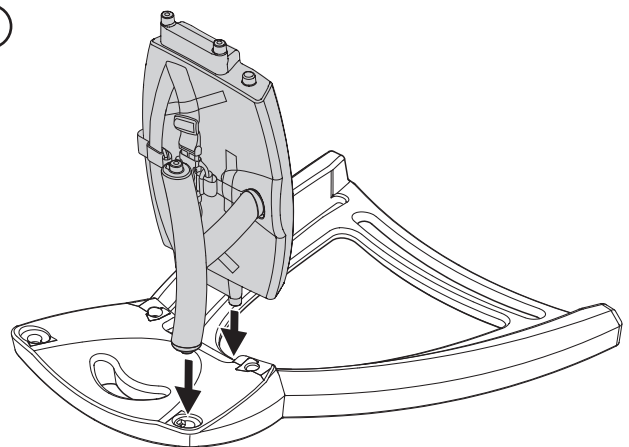

Lay x1 Side Support Leg on a flat surface
Insert 'T' Bar & Seat Pad into Side Support Leg
Push firmly to ensure a good fit



Magrini Limited

Unit 5, Maybrook Industrial Estate, Brownhills, Walsall WS8 7DG

Tel: 01543 375311 Fax: 01543 361172 www.magrini.co.uk

③

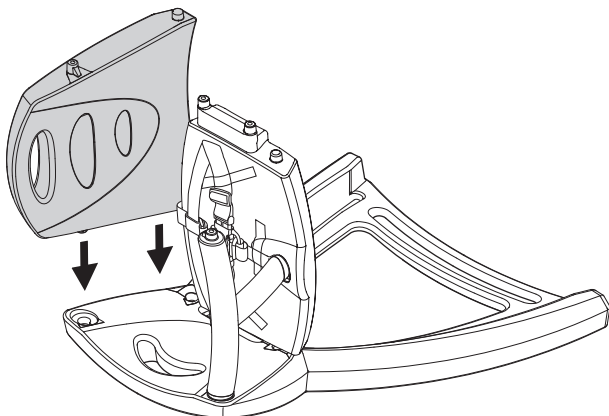

Insert Back Support. Push firmly to ensure a good fit
Note: Ensure Safety Strap is still taped to Seat Pad

④

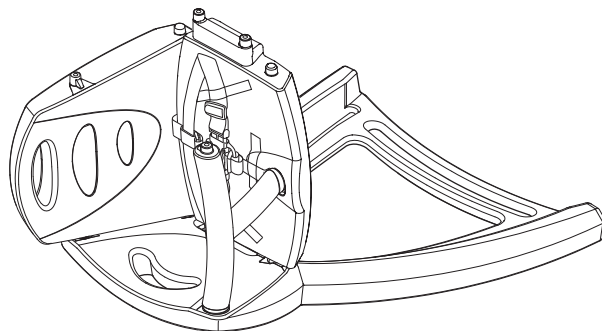

Make sure all components are located properly and pushed firmly together

⑤

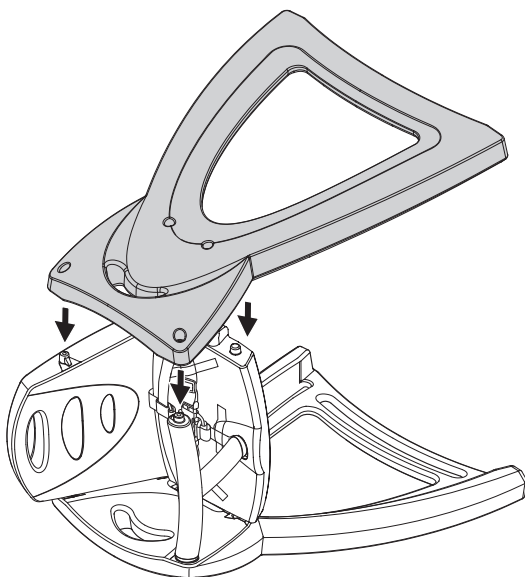

Locate other x1 Side Support Leg onto rest of already assembled components

⑥

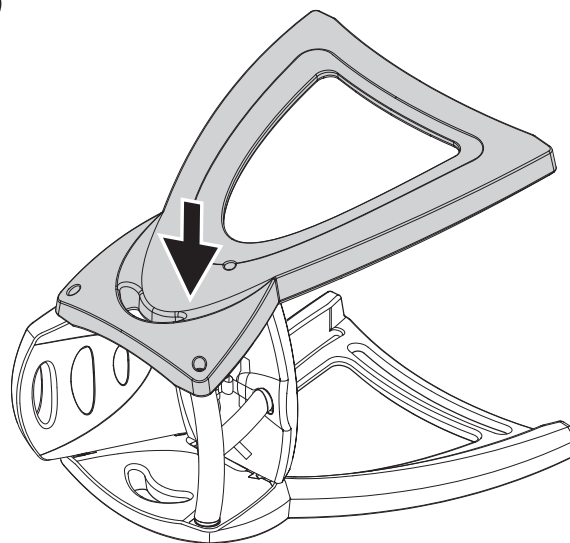

Push Side Support Leg firmly down to ensure a good fit

⑦

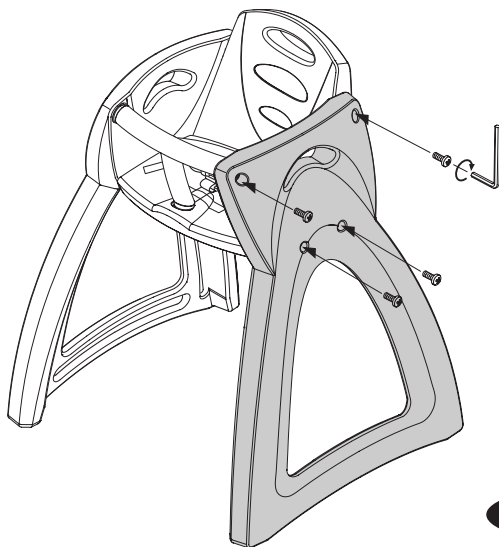

Stand chair upright and insert x4 Allen Bolts
Tighten securely using Allen Key provided

⑧

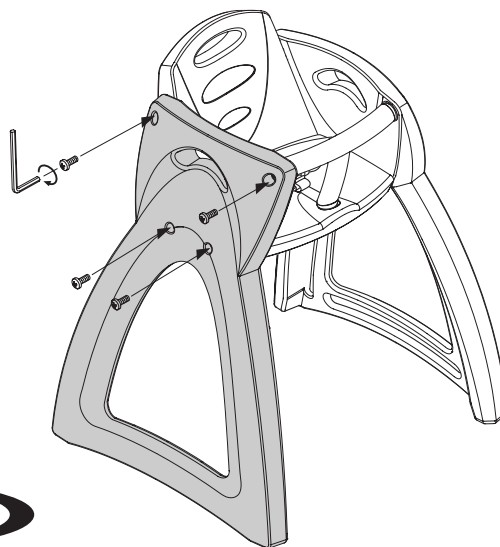

Rotate chair and insert other x4 Allen Bolts and tighten securely using Allen Key. Remove Tape from Strap
- Your chair is ready to use.