



Technical data sheet

EOS IR heating foils

IR heating foils for infrared warming cabins

Versatile IR heating foils specially designed for concealed installation in infrared warming cabins. They provide stable large-surface heat emission and are available in numerous sizes and power outputs. For domestic and commercial use.

Your advantages:

- Concealed installation - not visible inside the cabin.
- Automatic safety overheating limiter 110° C.
- High performance - working temperature approx. 100 °C.
- Mild long-wave IR-C heat emission range
- Large, almost full-surface heat emission zone.
- Available in 6 sizes and power outputs.
- Pre-mounted 1,3 m connection cable.
- Easy to install thanks to 40 mm circumferential rim.

Specifications and features:

Material:	flexible polyester foil with aluminium-based heating tracks. Heavy metal free
Infrared range:	long-wave (far infrared) >6 µm (IR-C)
Temperature range:	approx. 100 °C working temperature
Overheating protection:	automatic on-surface thermostatic limiter at 110 °C
Service life:	ca. 9.000 h or 6 years
Power range:	90 / 275 / 350 / 450 / 550 / 650 W
Sizes:	depending on power (see overleaf)
Power supply:	230 V 1N ~ 50/60 Hz
Installation:	wall-mounting, concealed installation inside wall structure. 40 mm rim on all sides for mechanical fixation.
Suitable control units:	Infratec Classic, Infratec Premium, EmoTec IR, InfraStyle, SBM-IR-Module.



Bottom side. Pre-mounted cable not shown.

Installation concept

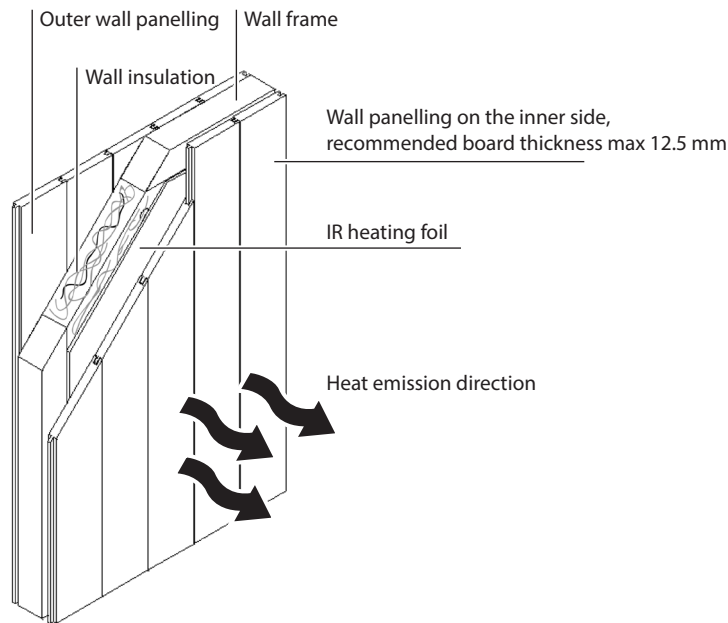

Mounting principle

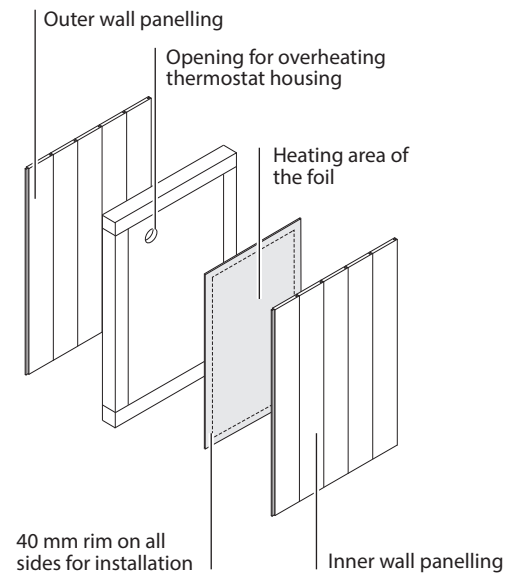

⚠ WARNING

Risk of fire by incorrect installation.

A faulty installation or later damaging poses the risk of fire. This risk also applies following completion of the installation work.

- Installation must only be carried out by a qualified specialist.
- The IR heating foils must be mounted only vertically with the overheating safety thermostat at the top.
- Protect IR heating foils from mechanical damages. Do not drill holes in the cabin wall, do not mount screws or nails as they can damage the foil.

Installation hints

- Bear in mind that the thickness of the inner wall cladding will directly influence the heat up speed.
- We recommend the inner wall cladding with maximum 12,5 mm thickness.
- Please pay attention that the heating foils may be fastened to the cabin wall structure only at the 40 mm rim. Do not screw, nail or tack them outside this zone! This will damage the heating tracks.

Technical specifications

Item no.	Electrical connection	Power output	Foil size (H x W)	Heating area (H x W)	Working temperature	Overheating temperature limit
94.3742	230 V 1N AC 50 Hz	650 W	1700 x 800 mm	1620 x 720 mm	100 °C	110 °C
94.3743		550 W	1450 x 800 mm	1370 x 720 mm		
94.3744		450 W	1600 x 600 mm	1520 x 520 mm		
94.3745		350 W	1250 x 600 mm	1170 x 520 mm		
94.3835		275 W	1600 x 400 mm	1520 x 320 mm		
94.3891		90 W	600 x 300 mm	520 x 220 mm		